

FIRST ANGLE PROJECTION

(ALL DIMENSIONS ARE IN mm)

DRG. NO. 3 - CPDC-0040/S

SHT. OF

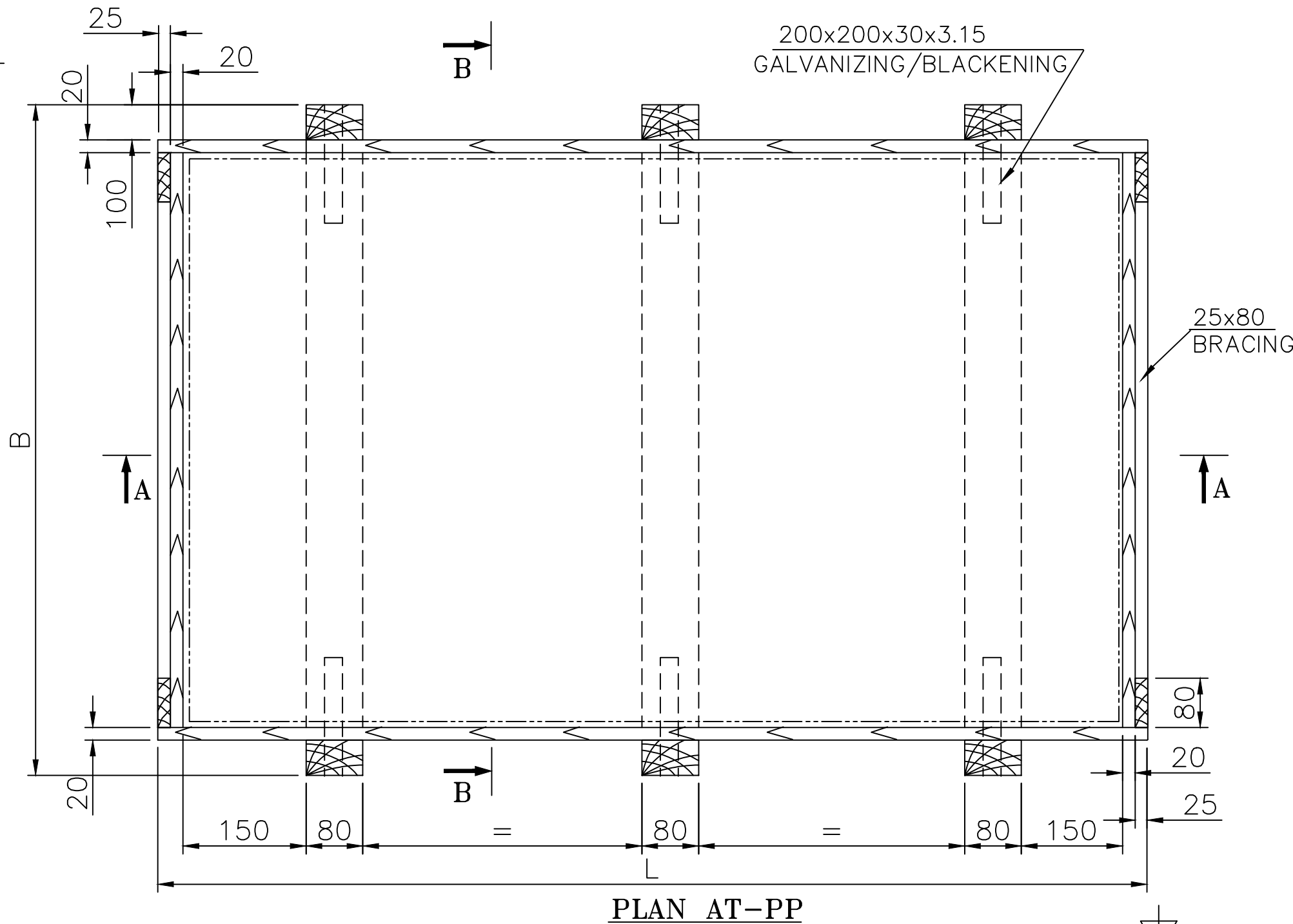
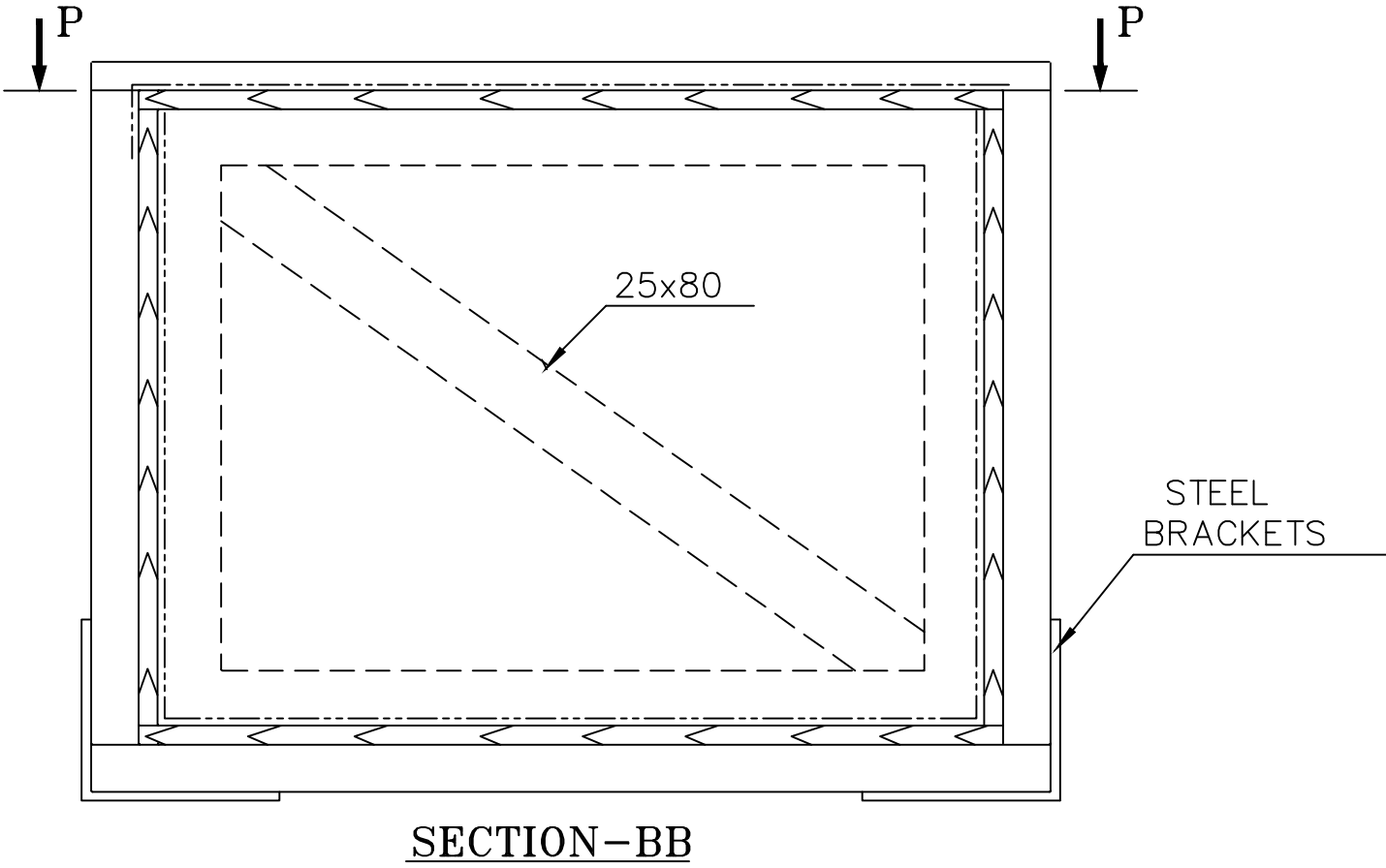
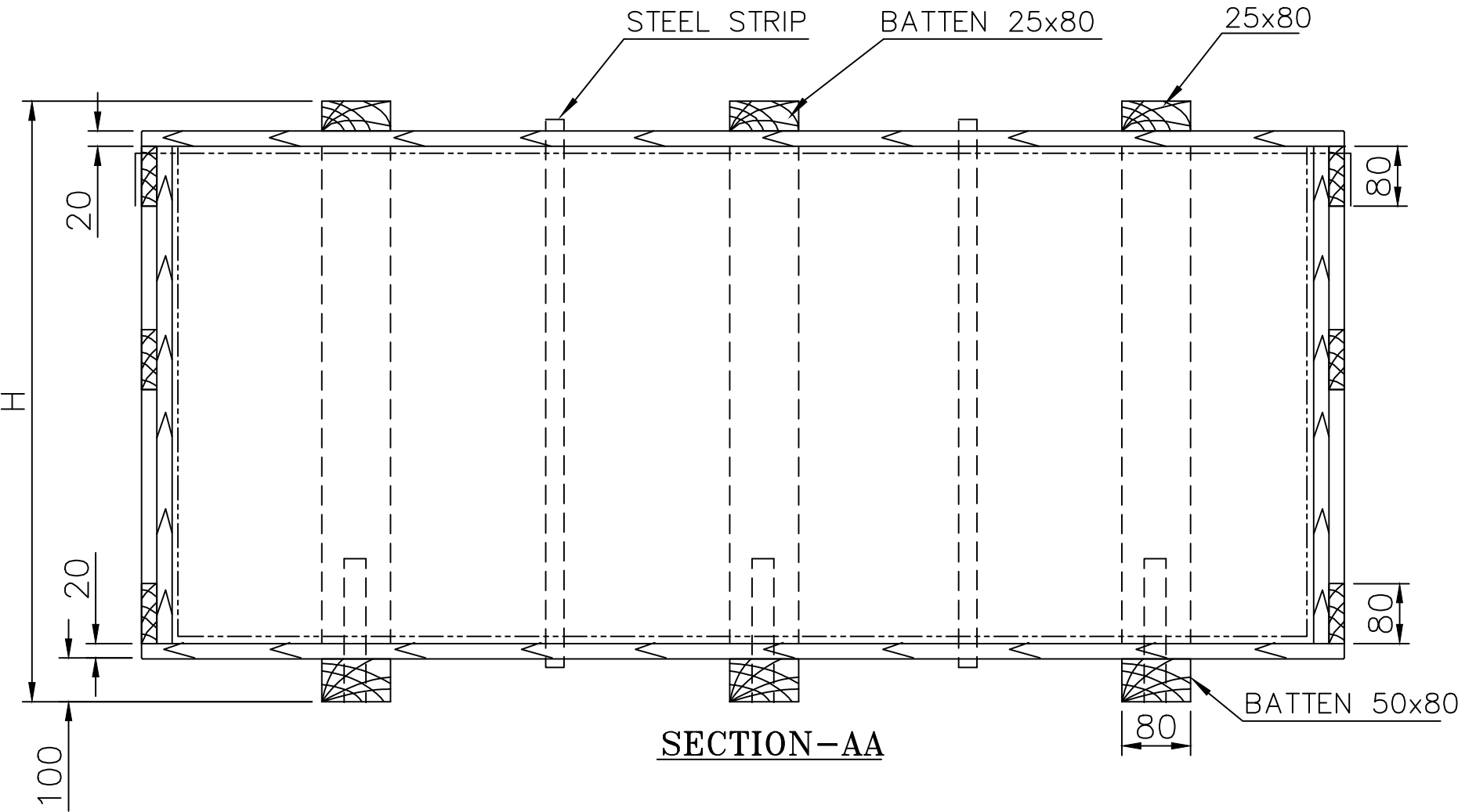

NOTE:

1. INSIDE DIMENSIONS LxBxH ARE TOBE MAINTAINED CORRECTLY.
2. WOOD SPECIFIED IN TO HY 51463.
3. CASE TO BE LINED WITH HESSAIN BITUMEN KRAFT PAPER HDPE TARPAULLIN 150GSM AT SIDES BOTTOM INSIDE AND TOP OUTSIDE AT TOP TO BE TURNED 80mm ON SIDES AND FIXED.
4. HDPE-TARPAULLIN 150GSM PLANKS 25mm THICK AT BOTTOM AND 20mm AT SIDES AND TOP.
5. SPACING BETWEEN BATTEN SHOULD BE NOT MORE THAN 300mm.

REV	DATE	ALTD.
02	09.03.04	APPD.
DRG. REVISED GENERALLY & CHEMICAL TREATMENT REMOVED		

$VOL = L \times B \times H$ (INCLUDING BATTENS)

TYPE OF PRODUCT OR NAME OF CUSTOMER/PROJECT					
(ABOVE 0.2 Cu.Mtrs & BELOW 1.0 Cu.Mtrs ONLY)					
Bharat Heavy Electricals Ltd. Hyderabad					
DEPT. CPDC		NAME		SIGN.	DATE
CODE 840		SYED NAZEER			27.07.02
UNTOL. DIMS. GR. ϕ /M/F		T.MURALI			27.07.02
SCALE NTS		C.V.SUBBA RAO			27.07.02
WEIGHT (KG) -NA-		REF. TO ASSY. DRG.		ITEM NO.	NO.OF ITEMS
TITLE		DRAWING NO.		REV.	
PACKING CASE FOR MISCELLANEOUS ITEM TYPE		3 - CPDC-0040/S		02	
CARD CODE		SHT. No		NO. OF SHT.	